

REPLACEMENT SET

POLY-SUMP FOR SUBMERSIBLE SEWAGE PUMPS

- Subsequent use of the existing sump
- No or minor field damage
- Corrosion-resistant materials
- Valve unit and pump with pressure pipe can be lifted out of sump

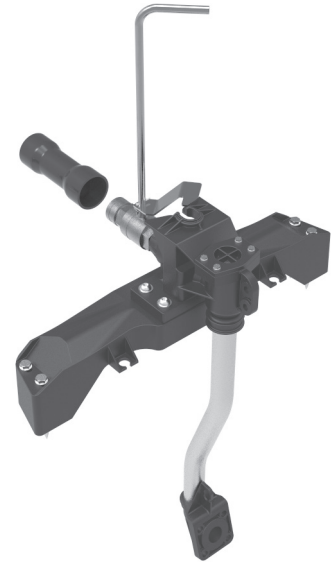

DESCRIPTION

The replacement set has been specially designed for the use in pump stations of pressure drainage systems from the years 1989-2007. It can be used in all situations where the age of the existing system or inadequate ventilation damaged the original components necessitate the replacement due to the aggressive conditions in the pump sump.

Where previously, due to cost considerations, it was standard practice to use grey cast iron and galvanised steel fixtures in pump chambers, this replacement set for single pump stations uses only corrosion-resistant materials such as stainless steel and modern glass-fibre reinforced plastics. They can be used to replace the existing fixtures on a one-to-one basis.

The existing sump can remain in the ground. When the replacement set is installed, the pressure pipe in the sump is usually disconnected. In special cases, the pressure pipe can also be disconnected with the appropriate accessories outside the sump.

With the replacement set, you can lift the pump and the discharge pipe assembly out of the sump in one piece for servicing. This gives you access to both the pump and the check valve, without having to climb into the chamber.

When deciding which replacement set model to use, refer to the year of manufacture of the plastic sump or contact us. We will be happy to assist!

In addition with the optional accessories for wall fastening and elevation adjustment other sumps with a diameter of 800-1000 mm can be equipped.

We can also advise you on which replacement set to use for other types of sump.

REPLACEMENT SET

POLY-SUMP FOR SUBMERSIBLE SEWAGE PUMPS

SCOPE OF SUPPLY

Replacement set for single units

Tie-bar and coupling system made of high-strength fibre-glass reinforced plastic, stainless-steel ball valve with extension and elastic connection (10 bar pressure-stable).

Discharge pipe assembly (accessory)

Stainless steel discharge with ball-check valve in high-strength plastic, pump tensile and certified chain in stainless steel

MECHANICAL DATA

Weight	78 kg
--------	-------

REPLACEMENT SET

Type	Code No.
Replacement Set (for the years 1989-2007)	JP48025

POSSIBLE PUMPS

Replacement Set	MultiCut 20/2 M plus, Ex	MultiCut 36/2 M
MultiCut 08/2 M	MultiCut 25/2 ME	MultiCut 36/2 M, Ex
MultiCut 08/2 M, Ex	MultiCut 25/2 ME, Ex	MultiCut 45/2 M
MultiCut 08/2 ME	MultiCut 35/2 M	MultiCut 45/2 M, Ex
MultiCut 20/2 M plus	MultiCut 35/2 M, Ex	

REPLACEMENT SET

POLY-SUMP FOR SUBMERSIBLE SEWAGE PUMPS

APPLICATION

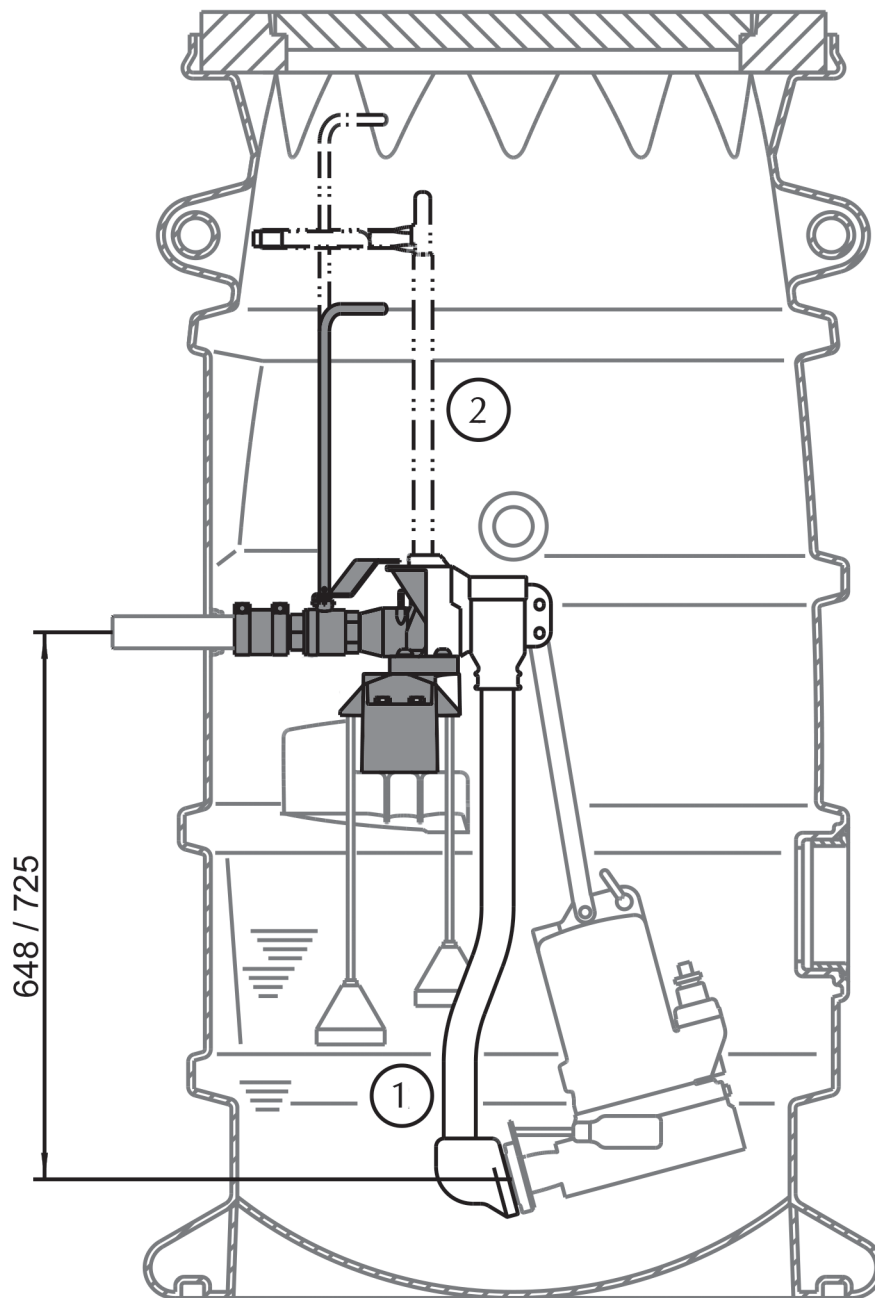

REPLACEMENT SET

POLY-SUMP FOR SUBMERSIBLE SEWAGE PUMPS

Example of installation wall fastening

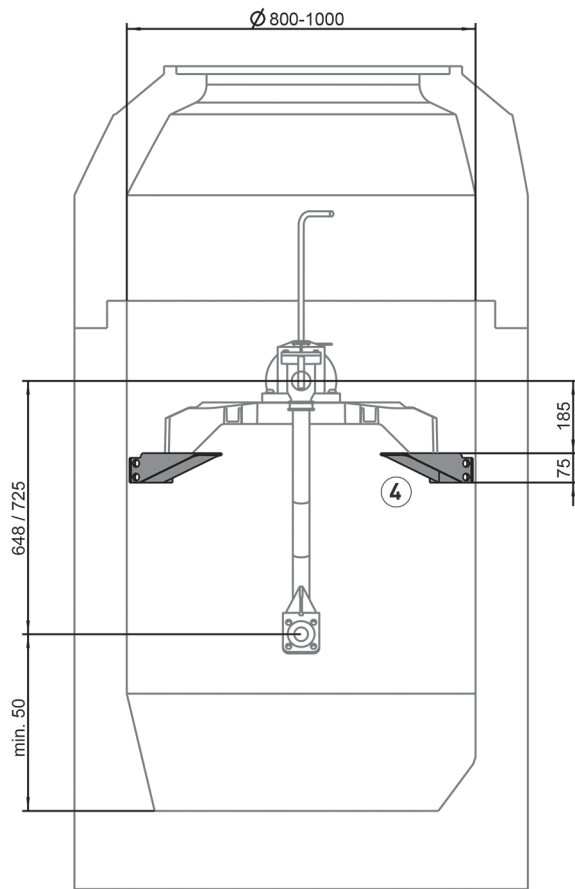

Example of installation height adjustment

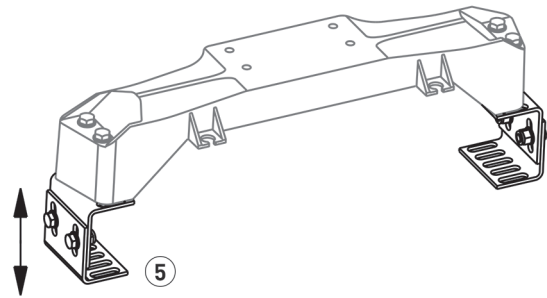

Example of installation connection pipe

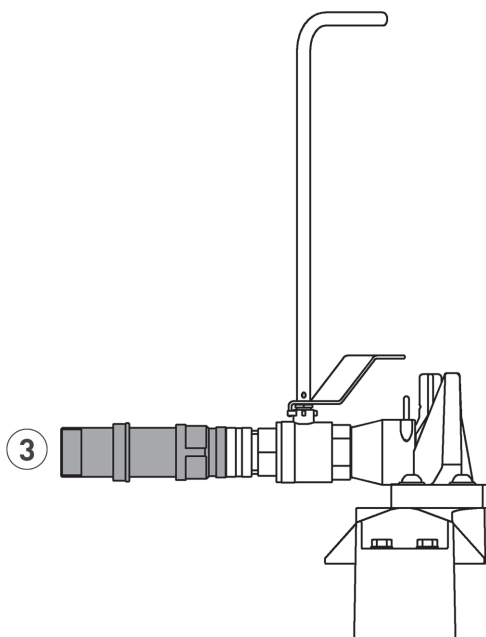

REPLACEMENT SET

POLY-SUMP FOR SUBMERSIBLE SEWAGE PUMPS

SUMP ACCESSORIES

			Code No.
① Discharge pipe assembly	Length 725, 1997-2007		JP42227
	Length 648, 1989-1996		JP46865
② Guide rail replacement set	1997-2007		JP48061
③ Connection pipe	2", when disconnecting outside the sump		JP48251
	1 1/2", when disconnecting outside the sump		JP48250
④ Wall fastening			JP48666
⑤ Height adjustment	96-147 mm		JP48667