

DRAINAGESET

DRAINAGE PUMPS

- Ready to connect
- Powerful drainage pump
- Large scope of supply
- For abrasive media
- Cooling jacket for motor housing
- SiC mechanical seal



DESCRIPTION

The Drainage Set reliably protects your building from mildly contaminated ground water. The set comes with the U6Drain ES drainage pump and is ready to plug in and use. The useful components contained in this set make it child's play to install and operate.

The powerful pump also handles drainage water with an abrasive sand content. Thanks to its slimline design, the drainage set fits in all standard drainage sumps with a sand trap from 280 mm internal diameter upwards. The mounting bracket stabilises the pump even in large sumps and ensures safe operation.

PERFORMANCE

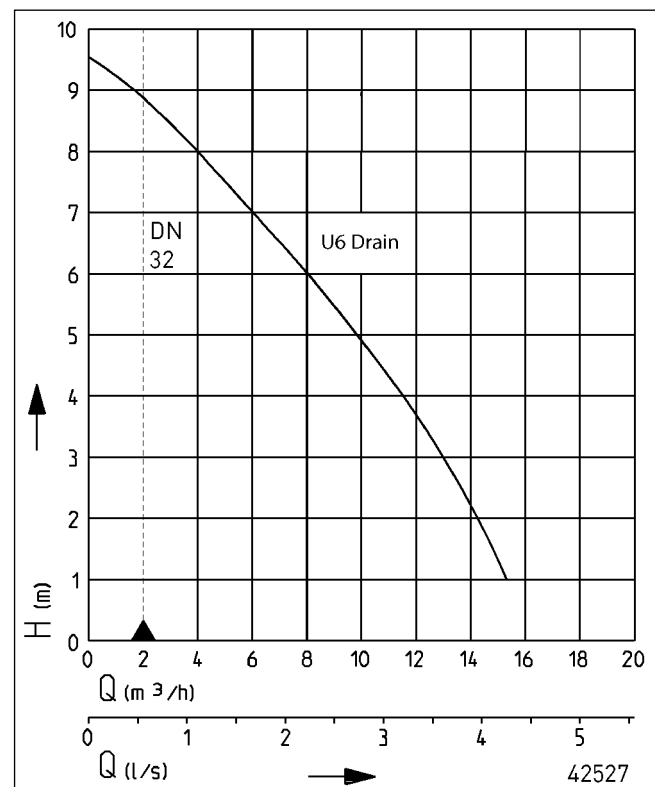

Type	Delivery head H [m]	1	2	3	4	5	6	7	8	9
Drainageset	Flow rate Q [m³/h]	15.5	14.0	12.5	11.0	9.0	7.5	5.5	3.5	1.5

Specifications can be changed without notice. Performance subject to ISO 9906 tolerances.

The minimum flow velocity in the pressure piping must be 0.7 m/s according to EN 12056.

This data is represented in the performance curve as a limit of application.

DRAINAGESET

DRAINAGE PUMPS

SCOPE OF SUPPLY

Drainage Set: Drainage pump U6 Drain ES, special float, swing-type check valve, hose nozzle with clamp, mounting bracket, 5 m lifting rope, 20 m cable, manual- 0- automatic

control switch.

Hose set: Elbow, 2 x hose nozzle, hose clamp, 15 m PVC spiral hose \varnothing 40 mm, hose clamp with wing bolt.

MECHANICAL DATA

Pump	Vertical single-stage	Shaft	Stainless steel
Free passage	10 mm	Impeller	Vortex impeller, GFK
Bearing	Ball bearings, grease-lubricated	Motor housing	Stainless steel
Seal on motor side	Rotary shaft seal	Submersible	Yes
Oil chamber	Yes	Mounted circuit	Yes
Seal on medium side	SiC mechanical seal	Pressure outlet	1 1/4"
Run dry protection	Yes	Weight	9 kg

ELECTRICAL DATA

Voltage	1/N/PE~230 V	Type of enclosure	IP 68
Motor rating P1	0.75 kW	Insulation class	B
Motor rating P2	0.49 kW	Winding thermostat	Yes
Current	3.3 A	Motor protection	Integrated
Power line	20m S07RN-F	Plug	Safety
Wires	4G0,75		

DRAINAGESET

Type	Code No.
Drainageset	JP43388

Dimensions and switching points Drainage Set (mm)

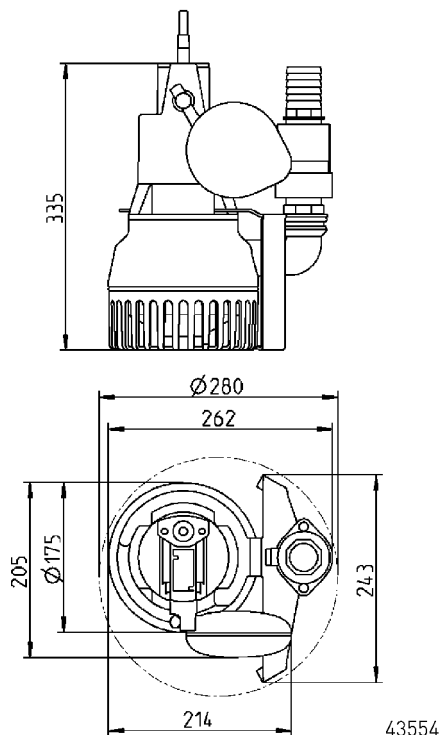

Example of installation with hose set

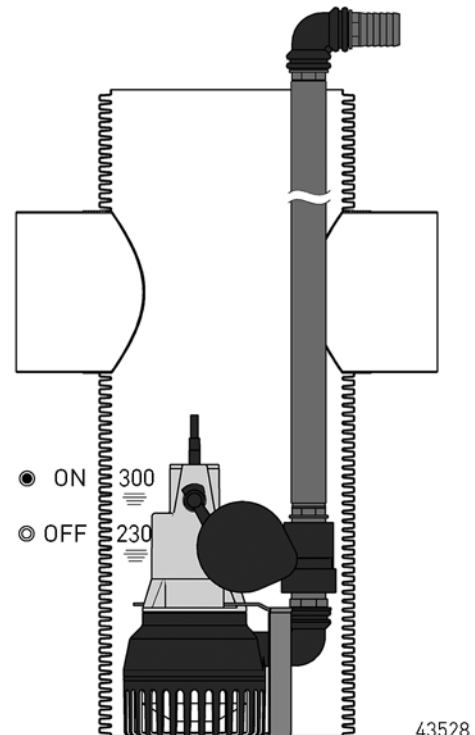

DRAINAGESET

DRAINAGE PUMPS

MECHANICAL ACCESSORY

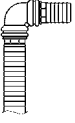
			Code No.
	1 Hose set	1 1/4" (DN32), 15 m PVC hose c/w elbow	JP43550

ELECTRICAL ACCESSORY

			Code No.
	b Rechargeable battery	9 V, for mains independent alarm	JP44850