

## PKS 1000 (65/80)

POLY-SUMP FOR SUBMERSIBLE SEWAGE PUMPS

- According EN 13598-2
- Suitable for traffic up to class D 400
- Corrosion-proof
- Buoyancy-proof and ground water proof
- Max. installation depth 4.90 m



### DESCRIPTION

The buoyancy proof and practicable plastic sump in high-grade polypropylene (PP) corresponds to EN 13598-2. It is used in pressure drainage systems as well as a standard pump sump. It is suitable for use in areas with traffic load up to 40 tons. (DIN EN 124, group 4). The PKS-D can be placed on natural ground without concrete works. The modular design offers easy transport and installation.

The sump has a connection piece for inlet, two sockets with seal for ventilation and cable duct, a facility for installing a flushing connection and a DN 80 pressure outlet.

The standard installation depth without a cover is 2.77 m. The installation depth can be extended to 5.90 m by the use of sump extensions (installation depth in ground water not more than 5 m). The total volume is 1764 litres. The storage volume below the inlet is 395 litres.

In order to adjust the pumping stations to the required pumping conditions a wide range of single channel impeller or vortex impeller pumps is available, both with or without explosion protection.

# PKS 1000 (65/80)

## POLY-SUMP FOR SUBMERSIBLE SEWAGE PUMPS

### SCOPE OF SUPPLY

#### PKS-D 1000-D65 /D80 (Duplex units)

The poly-sump consist of an underpart with an inlet and a discharge branch, an extension element with tie-bar, a cone 1000/625 and a concrete support ring for the manhole cover (accessory). The segments are sealed with sealing rings.

Inlet socket DN/OD 160 (DN 150) for PVC collar (KGU), 2 sockets DN 100 for ventilation/cable duct, 1 socket plug DN 100,

2 guide rail systems, pipework with non-return valves in DN 80, facility for flushing connection system "Perrot"

#### PKS 1000 (65/80)

Type	Code No.	Weight
PKS-D 1000 D65	<b>JP44379</b>	442 kg
PKS-D 1000 D80	<b>JP44381</b>	443 kg

#### POSSIBLE PUMPS

PKS-D 1000 D65	MultiFree 25/2 AW1, Ex	MultiFree 25/2 BW1
MultiStream 10/2 A1	MultiFree 35/2 AW1, Ex	MultiFree 35/2 BW1
MultiStream 15/2 A1	MultiFree 45/2 AW1, Ex	MultiFree 45/2 BW1
MultiStream 25/2 A2	PKS-D 1000 D80	MultiFree 25/2 BW1, Ex
MultiStream 35/2 A2	MultiStream 25/2 B1	MultiFree 35/4 BW1, Ex
MultiStream 10/2 A1, Ex	MultiStream 35/2 B2	MultiFree 45/2 BW1, Ex
MultiStream 15/2 A1, Ex	MultiStream 25/2 B1, Ex	MultiFree 15/4 BW1
MultiStream 25/2 A2, Ex	MultiStream 35/2 B2, Ex	MultiFree 25/4 BW1
MultiStream 35/2 A2, Ex	MultiStream 10/4 B1	MultiFree 35/4 BW1
MultiFree 10/2 AW1	MultiStream 15/4 B3	MultiFree 45/4 BW2
MultiFree 15/2 AW1	MultiStream 25/4 B4	MultiFree 15/4 BW1, Ex
MultiFree 25/2 AW1	MultiStream 35/4 B4	MultiFree 25/4 BW1, Ex
MultiFree 35/2 AW1	MultiStream 10/4 B1, Ex	MultiFree 35/4 BW1, Ex
MultiFree 45/2 AW1	MultiStream 15/4 B3, Ex	MultiFree 45/4 BW2, Ex
MultiFree 10/2 AW1, Ex	MultiStream 25/4 B4, Ex	
MultiFree 15/2 AW1, Ex	MultiStream 35/4 B4, Ex	

Sump depth in m	2.77	3.27	3.77	4.27	4.77
Required guide rail length in m	1,55 m	2,05 m	2,55 m	3,05 m	3,55 m
Bei Doppelanlagen bitte Gleitrohr 4x bestellen					

# PKS 1000 (65/80)

POLY-SUMP FOR SUBMERSIBLE SEWAGE PUMPS

## APPLICATION

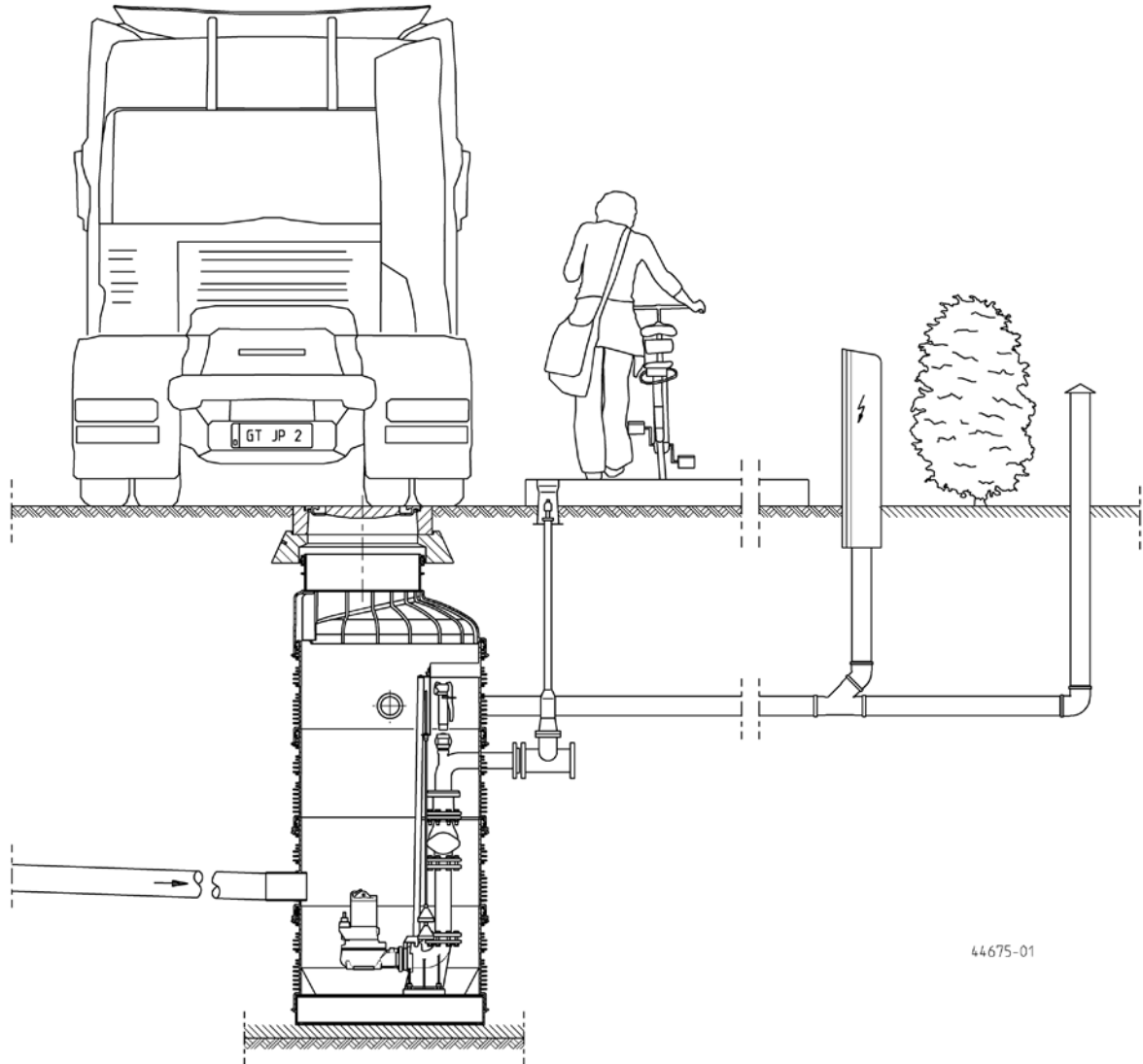

44675-01

Attention: Concerning space capacity the installation of submersible switches is not possible.

# PKS 1000 (65/80)

POLY-SUMP FOR SUBMERSIBLE SEWAGE PUMPS

PKS-D 1000-D65 and D80

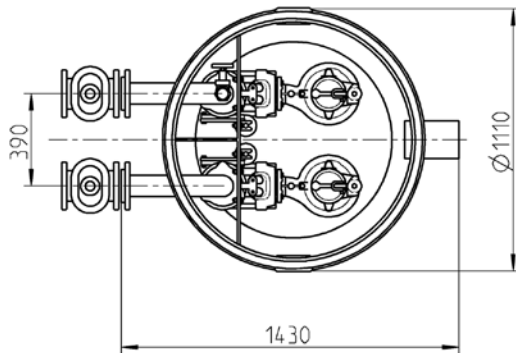
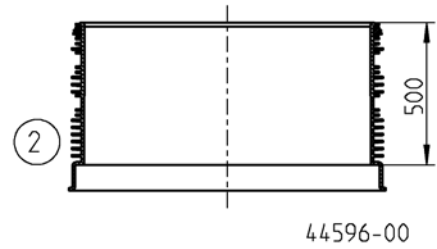
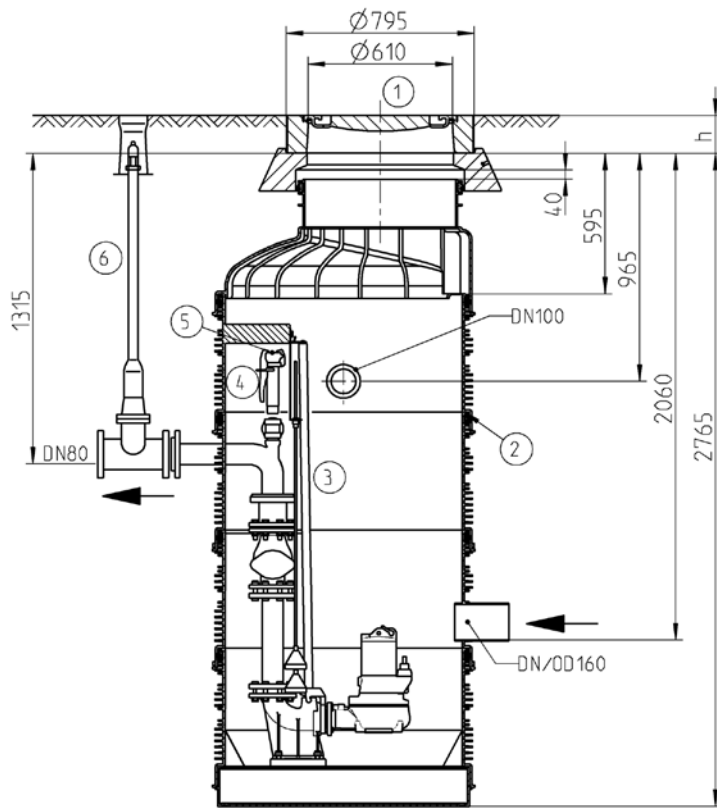





44593-01

# PKS 1000 (65/80)

POLY-SUMP FOR SUBMERSIBLE SEWAGE PUMPS

## SUMP ACCESSORIES

				Code No.
	<b>① Concrete cover</b>			
	Cover cl. B	Ø 610, h=125, D 750	110 kg	JP44972
	Cover cl. D	Ø 610, h=160	190 kg	JP29175
	<b>② Sump extension</b>	PSV-D 1000x500		JP44404
	<b>③ Guide rail, stainless steel</b>	1", 1550 mm, sump depth 2.77 m		JP50276
		1", 2050 mm, sump depth 3.27 m		JP50277
		1", 2550 mm, sump depth 3.77 m		JP50278
		1", 3050 mm, sump depth 4.27 m		JP50279
		1", 3550 mm, sump depth 4.77 m		JP50280
	<b>④ Perrot</b>	Flushing connection -65/80, 1/2"	3,2 kg	JP22353
	<b>Hose coupling</b>			
	Coupling Storz C	1/2" male thread		JP44770
	<b>⑤ Accessories for Perrot flushing connection</b>			
	Perrot DRS connection			JP22421
	Perrot breathing valve			JP22422
	Perrot pressure gauge			JP44854
	Perrot flush connection 1"			JP22466
	<b>⑥ Set of earth installation equipment</b>	Pipe cover 0,7 m		JP18938
		Pipe cover 1,0-1,4 m		JP18939
		Pipe cover 1,25-1,80 m		JP18940
		Erdeinbauschieber DN80		JP18936
	<b>⑦ Ventilation pipe</b>	DN 100 stainless steel, , 700 mm		JP44858
	<b>⑧ Second or changed inlet</b>	DN 150		JP44523
		DN 200		JP44524
		DN 250		JP44525
	<b>⑨ Seal lubricant</b>	1 kg tube (enough for 2 gaskets)		JP44605