

PKS 1000 (40)

POLY-SUMP FOR SUBMERSIBLE SEWAGE PUMPS

- According EN 13598-2
- Suitable for traffic up to class D 400
- Corrosion-proof
- Buoyancy-proof and ground water proof
- Max. installation depth 4.90 m



DESCRIPTION

The buoyancy proof and practicable plastic sump in high-grade polypropylene (PP) corresponds to EN 13598-2. It is used in pressure drainage systems as well as a standard pump sump. It is suitable for use in areas with traffic load up to 40 tons. (DIN EN 124, group 4). The PKS-D can be placed on natural ground without concrete works. The modular design offers easy transport and installation.

In order to adjust the pumping stations to the required pumping conditions a wide range of MultiCut submersible sewage pumps is available, both with or without explosion protection.

The sump is available in two versions, with a ladder (SG) using pumps MultiCut 20/2 M to 45/2 M and without a ladder using the larger MultiCut types 75/2 M and 76/2 M. Both versions have a connection piece for inlet, two sockets with seal for ventilation and cable duct, a facility for installing a flushing connection and a DN 40 pressure outlet.

The standard installation depth without a cover is 2.27 m. The installation depth can be extended to 4.90 m by the use of sump extensions (installation depth in ground water not more than 5 m). The total volume is 1372 litres. The volume storage below the inlet is 396 litres.

If extensions are used, one of the extensions must be ordered with a tie-bar.

PKS 1000 (40)

POLY-SUMP FOR SUBMERSIBLE SEWAGE PUMPS

SCOPE OF SUPPLY

PKS-D 1000-40 (single unit)

The poly-sump consist of an underpart with an inlet and a discharge branch, an extension element, a cone 1000/625 and a concrete support ring for the manhole cover (accessory). The segments are sealed with sealing rings. Inlet socket DN/OD 160 (DN 150) for PVC collar (KGU), 2 sockets DN 100 for ventilation/ cable duct, 1 socket plug DN 100, guide rail system, pipework with elbow ball check valve and stop valve in DN 40 in stainless steel, facility for flushing connection system "Perrot".

PKS-D 1000-D40 (duplex unit)

The poly-sump consist of an underpart with an inlet and a discharge branch, an extension element, a cone 1000/625 and a concrete support ring for the manhole cover (accessory). The segments are sealed with sealing rings. Inlet socket DN/OD 160 (DN 150) for PVC collar (KGU), 2 sockets DN 100 for ventilation/ cable duct, 1 socket plug DN 100, 2 guide rail systems, pipework with elbow ball check valves and stop valves in DN 40 in stainless steel, facility for flushing connection system "Perrot".

PKS 1000 (40)

Type	Code No.	Weight
PKS-D 1000-40	JP44358	295 kg
PKS-D 1000-D40	JP44359	330 kg
PKS-D 1000-D40 (75)	JP44361	330 kg

POSSIBLE PUMPS

PKS-D 1000-40	MultiCut 45/2 M	MultiCut 36/2 M
MultiCut 20/2 M plus	PKS-D 1000-D40	MultiCut 45/2 M
MultiCut 25/2 ME	MultiCut 20/2 M plus	PKS-D 1000-D40 (75)
MultiCut 35/2 M	MultiCut 25/2 ME	MultiCut 75/2 M
MultiCut 36/2 M	MultiCut 35/2 M	MultiCut 76/2 M

Sump depth in m	2.27	2.77	3.27	3.77	4.27	4.77
Required guide rail length in m	1,15	1,65	2,15	2,65	3,15	3,65
For duplex units please order 2 x guide tubes						

PKS 1000 (40)

POLY-SUMP FOR SUBMERSIBLE SEWAGE PUMPS

APPLICATION

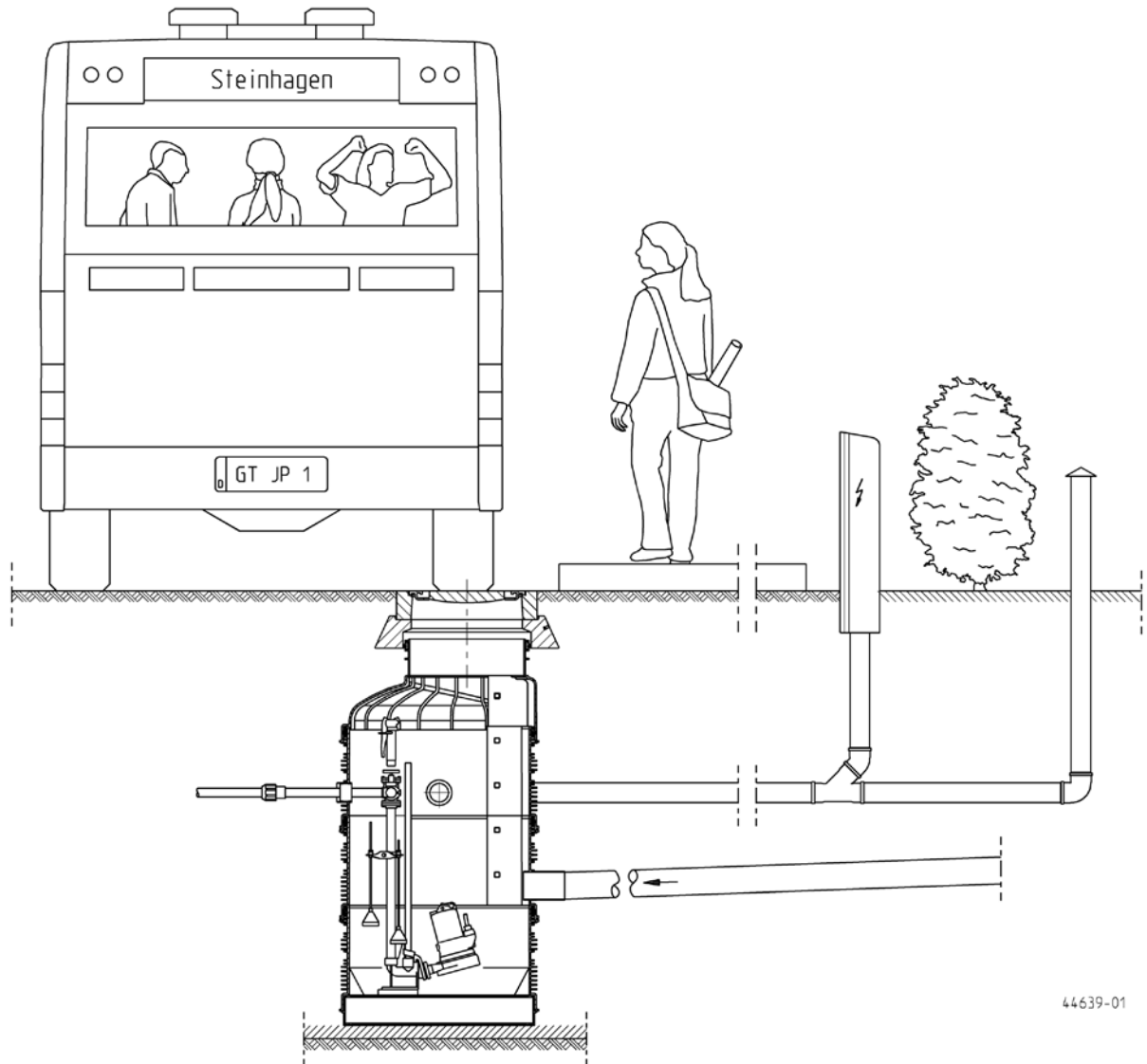

44639-01

Attention: Concerning space capacity the installation of submersible switches is not possible.

PKS 1000 (40)

POLY-SUMP FOR SUBMERSIBLE SEWAGE PUMPS

PKS-D 1000-40/PKS-D 1000-D40

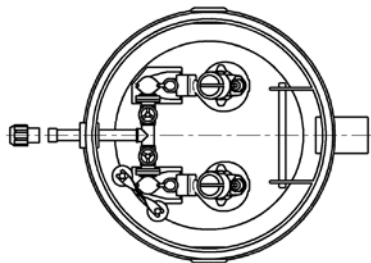
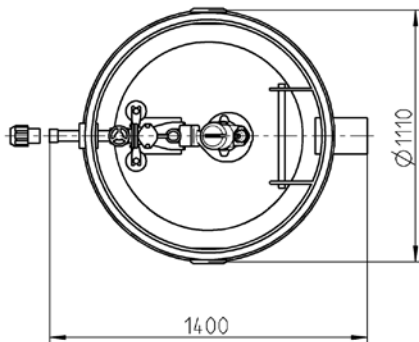
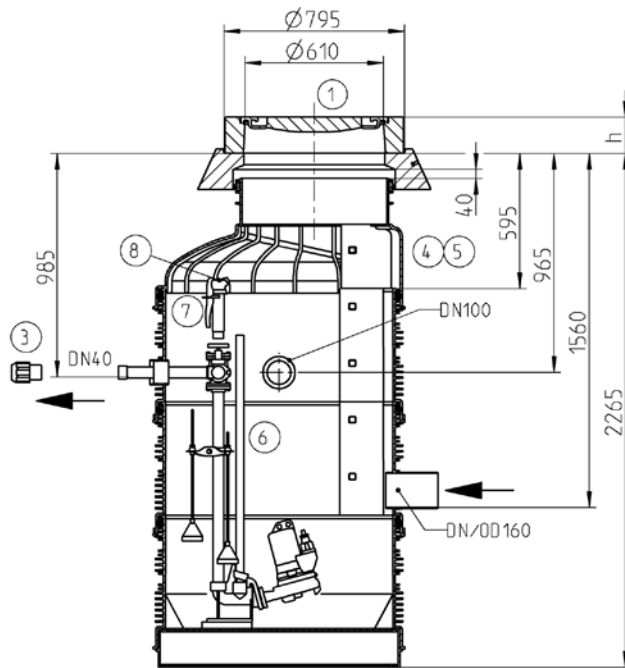

44597-03

with ladder/without ladder

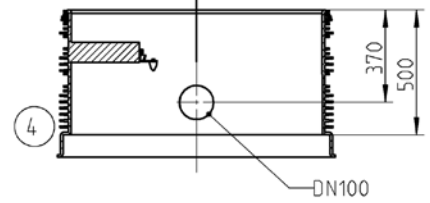
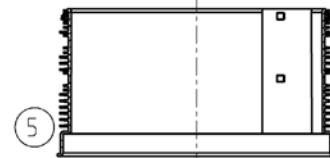
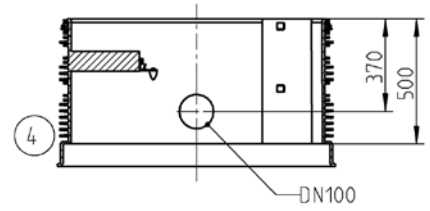





SUMP ACCESSORIES

			Code No.
<input type="checkbox"/>	1 Concrete cover		
<input type="checkbox"/>	Cover cl. B	Ø 610, h=125, D 750	110 kg JP44972
<input type="checkbox"/>	Cover cl. D	Ø 610, h=160	190 kg JP29175

PKS 1000 (40)

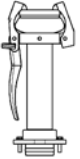
POLY-SUMP FOR SUBMERSIBLE SEWAGE PUMPS

SUMP ACCESSORIES

			Code No.
	② Access aid		
	Access aid, grab handle		JP44610
	Access aid, sleeve		JP44611
	③ Screwed joint		
	1 1/2" to Ø 50 mm (DN 40)	with female thread and clamping connection	JP45948
	1 1/2" to Ø 63 mm (DN 50)	with female thread and clamping connection	JP45949
	④ Sump extension	PSV-D 1000x500 Tie-bar, ladder 34,0 kg	JP44407
		PSV-D 1000x500 T Tie-bar	JP44408
	⑤ Sump extension	PSV-D 1000x500 SG Ladder 16,6 kg	JP44403
		PSV-D 1000x500	JP44404
	⑥ Guide rail, stainless steel	1", 1150 mm, sump depth 2,27 m 2,8 kg	JP50268
		1", 1650 mm, sump depth 2,77 m 4,0 kg	JP50269
		1", 2150 mm, sump depth 3,27 m 5,2 kg	JP50270
		1", 2650 mm, sump depth 3,77 m 6,5 kg	JP50271
		1", 3150 mm, sump depth 4,27 m 7,5 kg	JP50272
		1", 3650 mm, sump depth 4,77 m 9,0 kg	JP50273
	⑦ Perrot	Flushing connection -32/40, galvanised	JP42059
	⑧ Accessories for Perrot flushing connection		
	Perrot hose connection	Ø 50 mm	JP19202
	Perrot DRS connection		JP22421
	Perrot breathing valve		JP22422
	Perrot pressure gauge		JP44854
	Perrot claw coupling		JP22420
	Perrot flush connection 1"		JP22466
	⑨ Ventilation pipe	DN 100 stainless steel, , 700 mm	JP44858
	⑩ Second or changed inlet	DN 150	JP44523
		DN 200	JP44524
		DN 250	JP44525
	⑪ Seal lubricant	1 kg tube (enough for 2 gaskets)	JP44605
		3 kg bucket	JP44606
	⑫ Dislocate of grafity center	MultiCut 75... and 76...	JP44757