

## PKS 1000 (40)

STATIONS DE POMPAGE EN PLASTIQUE POUR POMPES D'ASSAINISSEMENT

EMENT

- Conformément à la norme EN 13598-2
- Carrossable cl. D 400
- Résistant à la corrosion
- Auftriebssicher und grundwasserdicht
- Profondeur maximale d'installation 4,90 m



### DESCRIPTION

The buoyancy proof and practicable plastic sump in high-grade polypropylene (PP) corresponds to EN 13598-2. It is used in pressure drainage systems as well as a standard pump sump. It is suitable for use in areas with traffic load up to 40 tons. (DIN EN 124, group 4). The PKS-D can be placed on natural ground without concrete works. The modular design offers easy transport and installation.

In order to adjust the pumping stations to the required pumping conditions a wide range of MultiCut submersible sewage pumps is available, both with or without explosion protection.

The sump is available in two versions, with a ladder (SG) using pumps MultiCut 20/2 M to 45/2 M and without a ladder using the larger MultiCut types 75/2 M and 76/2 M. Both versions have a connection piece for inlet, two sockets with seal for ventilation and cable duct, a facility for installing a flushing connection and a DN 40 pressure outlet.

The standard installation depth without a cover is 2.27 m. The installation depth can be extended to 4.90 m by the use of sump extensions (installation depth in ground water not more than 5 m). The total volume is 1372 litres. The volume storage below the inlet is 396 litres.

If extensions are used, one of the extensions must be ordered with a tie-bar.

# PKS 1000 (40)

## STATIONS DE POMPAGE EN PLASTIQUE POUR POMPES D'ASSAINISSEMENT

### LIVRAISON

#### PKS-D 1000-40 (single unit)

The poly-sump consist of an underpart with an inlet and a discharge branch, an extension element, a cone 1000/625 and a concrete support ring for the manhole cover (accessory). The segments are sealed with sealing rings. Inlet socket DN/OD 160 (DN 150) for PVC collar (KGU), 2 sockets DN 100 for ventilation/cable duct, 1 socket plug DN 100, guide rail system, pipework with elbow ball check valve and stop valve in DN 40 in stainless steel, facility for flushing connection system "Perrot".

#### PKS-D 1000-D40 (duplex unit)

The poly-sump consist of an underpart with an inlet and a discharge branch, an extension element, a cone 1000/625 and a concrete support ring for the manhole cover (accessory). The segments are sealed with sealing rings. Inlet socket DN/OD 160 (DN 150) for PVC collar (KGU), 2 sockets DN 100 for ventilation/cable duct, 1 socket plug DN 100, 2 guide rail systems, pipework with elbow ball check valves and stop valves in DN 40 in stainless steel, facility for flushing connection system "Perrot".

### PKS 1000 (40)

Type	Art.-Nr.	Poids
PKS-D 1000-40	<b>JP44358</b>	295 kg
PKS-D 1000-D40	<b>JP44359</b>	330 kg
PKS-D 1000-D40 (75)	<b>JP44361</b>	330 kg

### POMPES UTILISABLES

PKS-D 1000-40	MultiCut 45/2 M	MultiCut 36/2 M
MultiCut 20/2 M plus	PKS-D 1000-D40	MultiCut 45/2 M
MultiCut 25/2 ME	MultiCut 20/2 M plus	PKS-D 1000-D40 (75)
MultiCut 35/2 M	MultiCut 25/2 ME	MultiCut 75/2 M
MultiCut 36/2 M	MultiCut 35/2 M	MultiCut 76/2 M

Profondeur de la cuve en m	2,27	2,77	3,27	3,77	4,27	4,77
longueur de tube requis en m	1,15	1,65	2,15	2,65	3,15	3,65
For duplex units please order 2 x guide tubes						

# PKS 1000 (40)

STATIONS DE POMPAGE EN PLASTIQUE POUR POMPES D'ASSAINISSEMENT

## APPLICATION

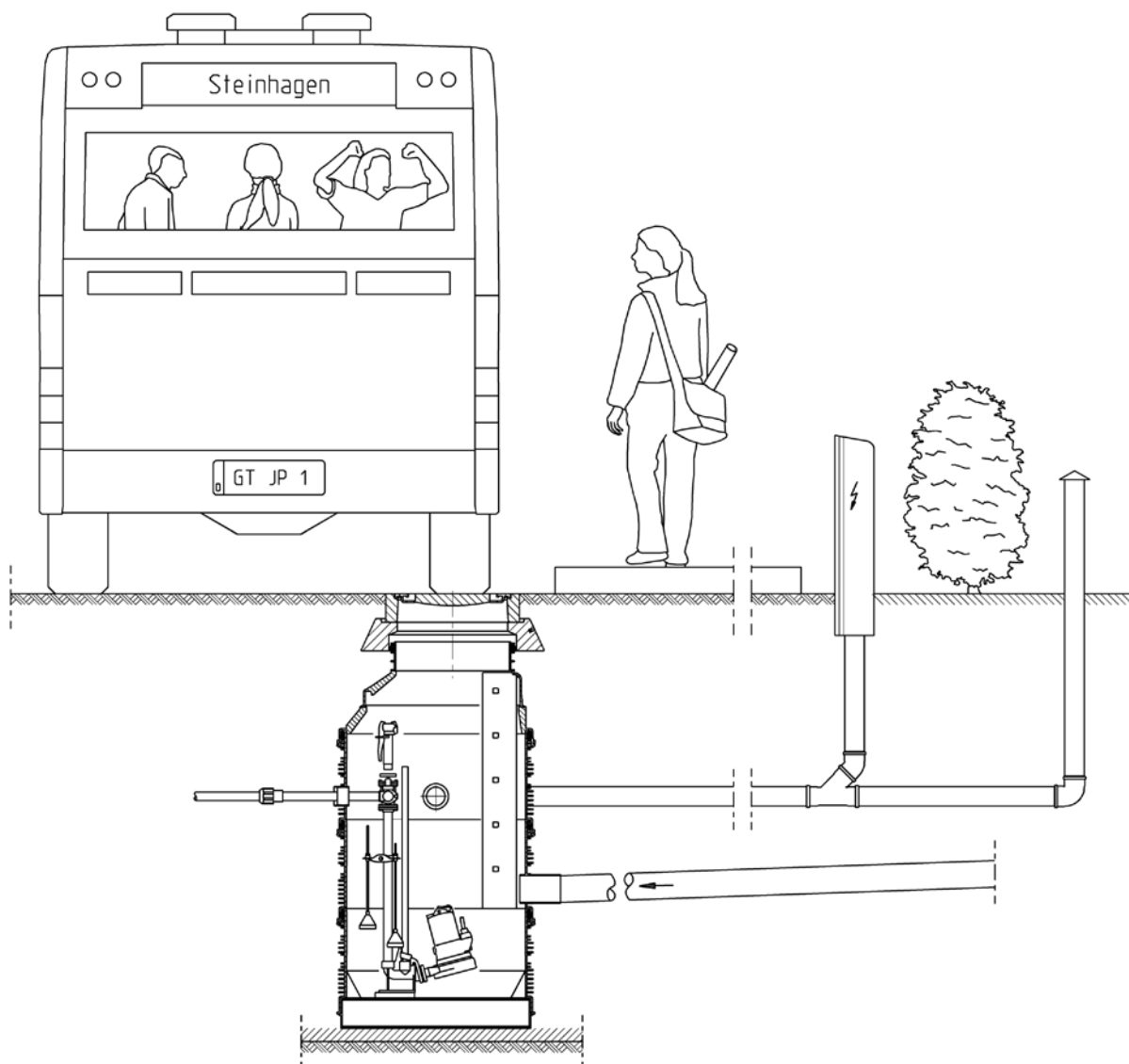

Attention ! Pour des raisons de place, il n'est pas possible d'utiliser des interrupteurs à immersion.

# PKS 1000(40)

STATIONS DE POMPAGE EN PLASTIQUE POUR POMPES D'ASSAINISSEMENT

PKS-D 1000-40/PKS-D 1000-D40

with ladder/without ladder

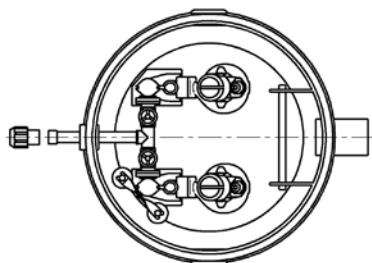
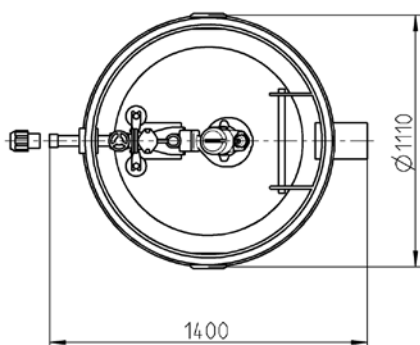
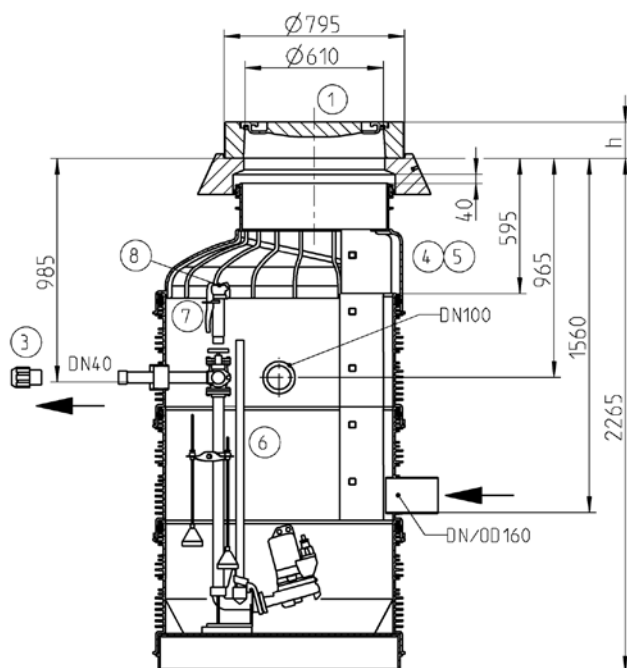



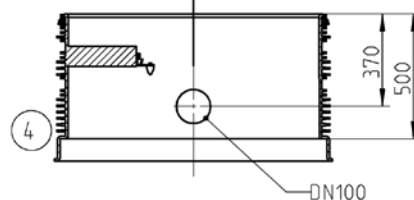
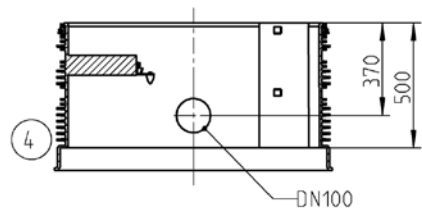



44597-03

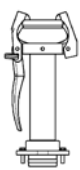

# PKS 1000(40)

STATIONS DE POMPAGE EN PLASTIQUE POUR POMPES D'ASSAINISSEMENT

## ACCESSOIRES DE L'ARBRE

				Art.-Nr.
	<b>① Recouvrement</b>			
	Recouvrement sans aération Cl. Ø 610 Cl. B 125, h= 125	110 kg		JP44972
	B d610			
	Recouvrement sans aération Cl. without ventilation, Ø 610, h=160	190 kg		JP29175
	C d610			
	<b>② Crosse</b>			
	Crosse, barre de maintien			JP44610
	Crosse, guide			JP44611
	<b>③ Raccord de refoulement à serrage</b>			
	1 1/2" sur Ø 50 mm (DN 40)	avec manchon de serrage		JP45948
	1 1/2" sur Ø 63 mm (DN 50)	avec manchon de serrage		JP45949
	<b>④ Rehausse</b>	Traverse avec échelons	Traverse, Steiggang	34,0 kg
		PSV-D 1000x500 T	Traverse	JP44407
				JP44408
	<b>⑤ Rehausse</b>	Échelons	Steiggang	16,6 kg
		PSV-D 1000x500		JP44403
				JP44404
	<b>⑥ Barre de guidage, acier inox</b>	1" 1150 mm, profondeur de la cuve, 2,27 m	2,8 kg	JP50268
		1" 1650 mm, profondeur de la cuve, 2,77 m	4,0 kg	JP50269
		1" 2150 mm, profondeur de la cuve, 3,27 m	5,2 kg	JP50270
		1" 2650 mm, profondeur de la cuve, 3,77 m	6,5 kg	JP50271
		1" 3150 mm, profondeur de la cuve, 4,27 m	7,5 kg	JP50272
		1" 3650 mm, profondeur de la cuve, 4,77 m	9,0 kg	JP50273
	<b>⑦ Perrot</b>	Raccord de purge -32/40, galvanisé		JP42059
	<b>⑧ Accessoires pour raccord de purge perrot</b>			
	Raccord de flexible	Ø 50 mm		JP19202
	Raccord DRS			JP22421
	Brise vacuum			JP22422
	Système de manomètre			JP44854
	Accouplement à griffes			JP22420
	Embout taraudé 1"			JP22466
	<b>⑨ Tuyau d'aération</b>	DN 100 Acier Inox, 700 mm		JP44858
	<b>⑩ Deuxième entrée</b>	DN 150		JP44523
		DN 200		JP44524
		DN 250		JP44525
	<b>⑪ Lubrifiant</b>	Tube 1 kg (suffisant pour 2 joints)		JP44605
		3 kg seau		JP44606
	<b>⑫ Transfert du centre de gravité</b>	MultiCut 75... et 76...		JP44757