

Ersatzteile - Spare parts - Pièces de rechange - Reserveonderdelen - Parti di ricambio - Reservedele - Reservdelar
 Varaosat - Części zamienne - Náhradní díly - Alkatrészek - Piese de schimb - Запасные части - 备件



①



②



③



④

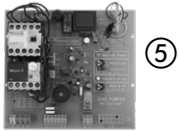

⑤

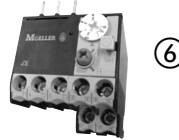

⑥



⑦

①	Gehäuse A	Housing A	JP47692
②	Scharnier	Hinge	JP48310
③	Wippschalter	Switch, 3 positions	JP47783
④	Betriebsstundenzähler	Operation hours counter	JP47672
⑤	Gedruckte Schaltung	PCB	
	AD 00E		JP47712
	AD 00		JP46846
	AD 25		JP46839
	AD 46		JP47717
	AD 610		JP47726
	AD 910		JP48313
⑥	Überstromrelais	Overcurrent relay	
	ZE-4	2,4-4 A	JP47779
	ZE-6	4-6 A	JP47780
	ZE-9	6-9 A	JP47781
⑦	Schütz	Contactor	
	DIL EM 10		JP47671
	DIL EM 12-15		JP48311

Ersatzteile - Spare parts - Pièces de rechange - Reserveonderdelen - Parti di ricambio - Reservedele - Reservdelar
 Varaosat - Części zamienne - Náhradní díly - Alkatrészek - Piese de schimb - Запасные части - 备件



①



②

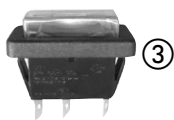

③

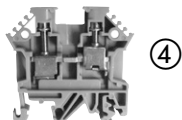

④



⑤

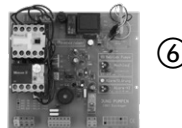

⑥



⑦



⑧



⑨



⑩

①	Gehäuse A	Housing A	JP47692
②	Scharnier	Hinge	JP48310
③	Wippschalter	Switch, 3 positions	JP47783
④	Klemme RK 2,5-4	Terminal RK 2,5-4	JP48308
⑤	Betriebsstundenzähler	Operation hours counter	JP47672
⑥	Gedruckte Schaltung	PCB	JP47304
⑦	Motorschutzschalter	Protective motor switch	
	2,5-4 A		JP47753
	4-6,3 A		JP47754
	6,3-10 A		JP47755
⑧	Schütz	Contactor	
	DIL EM 10		JP47671
	DIL EM 12-15		JP48311
⑨	Kondensator	Capacitor	
	30 µF 400V DB		JP47740
⑩	Schmelzeinsatz 10A, 400V	Fuse cartridge 10A 400V	JP47762

Ersatzteile - Spare parts - Pièces de rechange - Reserveonderdelen - Parti di ricambio - Reservedele - Reservdelar
 Varaosat - Części zamienne - Náhradní díly - Alkatrészek - Piese de schimb - Запасные части - 备件



①



②



③



④

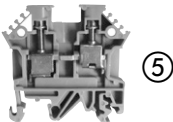

⑤



⑥



⑦



⑧



⑨



⑩



⑪

① Gehäuse ADP	Housing ADP	JP47692
② Scharnier	Hinge	JP48310
③ Wippschalter	Switch, 3 positions	JP47783
④ Taster	Button	JP48309
⑤ Klemme RK 2,5-4	Terminal RK 2,5-4	JP48308
⑥ Betriebsstundenzähler	Operation hours counter	JP47672
⑦ Gedruckte Schaltung	PCB	
	AD 4 ExW	JP47724
	AD 8 ExW	JP47724
	AD 23 Ex	JP48491
	AD 25 Ex	JP47723
	AD 46 Ex	JP47725
	AD 610 Ex	JP47727
	AD 910 Ex	JP48314
⑧ Überstromrelais	Overcurrent relay	
	ZE-2,4 1,6-2,4 A	JP47778
	ZE-4 2,4-4 A	JP47779
	ZE-6 4-6 A	JP47780
	ZE-9 6-9 A	JP47781
	ZE-12 9-12 A	JP48312
⑨ Schütz	Contactor	
	DIL EM 10	JP47671
	DIL EM 12-15	JP48311
⑩ Motorschutz	Motor protection	
	4A ETA	JP48490
	8A ETA	JP47683
⑪ Kondensator	Capacitor	
	8 µF	JP46357
	20 µF	JP46016

Ersatzteile - Spare parts - Pièces de rechange - Reserveonderdelen - Parti di ricambio - Reservedele - Reservdelar
 Varaosat - Części zamienne - Náhradní díly - Alkatrészek - Piese de schimb - Запасные части - 备件



①



②



③



④



⑤



⑥



⑦



⑧

① Gehäuse A	Housing A	JP47692
② Scharnier	Hinge	JP48310
③ Wippschalter	Switch, 3 positions	JP47783
④ Taster	Button	JP48309
⑤ Betriebsstundenzähler	Operation hours counter	JP47672
⑥ Gedruckte Schaltung	PCB	JP47736
⑦ Motorschutzschalter	Protective motor switch	
	1,6-2,5 A	JP47752
	2,5-4 A	JP47753
	4-6,3 A	JP47754
	6,3-10 A	JP47755
⑧ Schütz	Contactor	
	DIL EM 10	JP47671
	DIL EM 12-15	JP48311

BASICLOGO AD ... XM / BASICLOGO AD ... EXM, TLS

Ersatzteile - Spare parts - Pièces de rechange - Reserveonderdelen - Parti di ricambio - Reservedele - Reservdelar
 Varaosat - Części zamienne - Náhradní díly - Alkatrészek - Piese de schimb - Запасные части - 备件

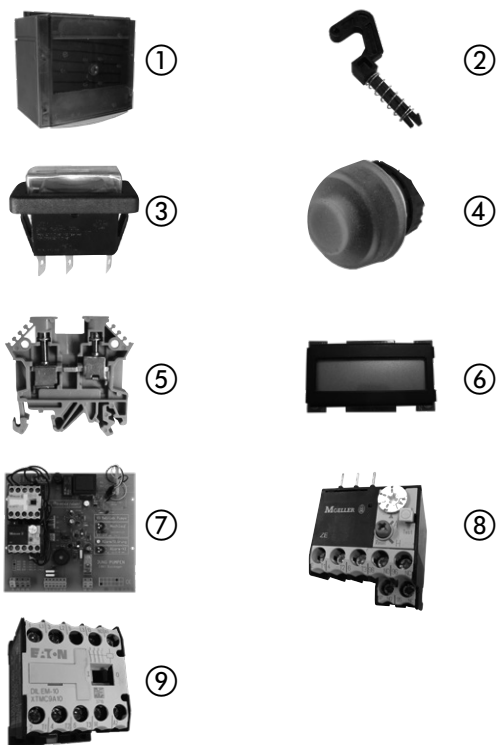

①	Gehäuse ADP	Housing ADP	JP47692
②	Scharnier	Hinge	JP48310
③	Wippschalter	Switch, 3 positions	JP47783
④	Taster	Button	JP48309
⑤	Klemme RK 2,5-4	Terminal RK 2,5-4	JP48308
⑥	Betriebsstundenzähler	Operation hours counter	JP47672
⑦	Gedruckte Schaltung	PCB	
	AD 25 ExM		JP47706
	AD 46 ExM		JP47707
	AD 610 ExM		JP47709
⑧	Überstromrelais	Overcurrent relay	
	ZE-4 2,4-4 A		JP47779
	ZE-6 4-6 A		JP47780
	ZE-9 6-9 A		JP47781
⑨	Schütz DIL EM 10	Contactor DIL EM 10	JP47671

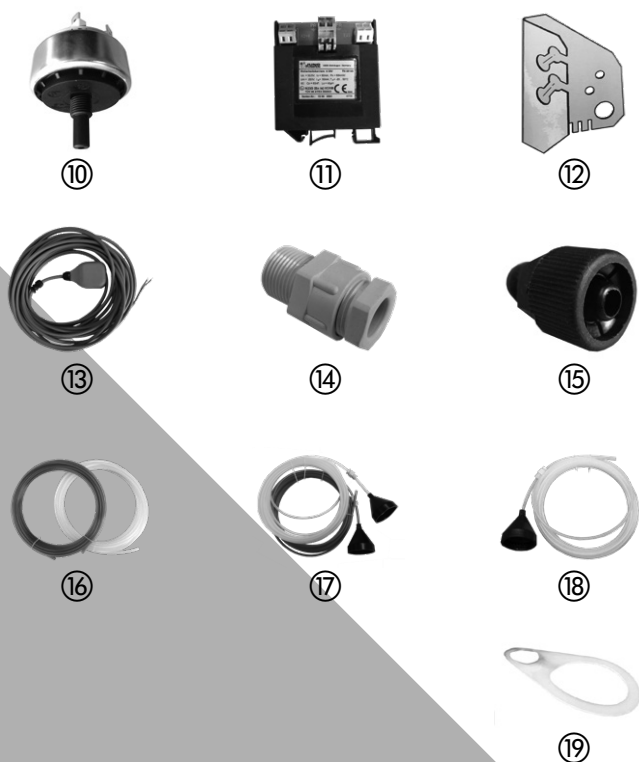

	Niveaugeber	Level detector	
⑩	Druckschalter 100/50	Pressure switch	JP47699
⑪	Sicherheitsbarriere	Safety barrier ATEX	JP46348
⑫	TLS Halter		JP46456
⑬	TLS Tauchschalter 9,5m		JP48304
	TLS Tauchschalter 15 m		JP48873
	TLS Tauchschalter 20 m		JP47771
	TLS Tauchschalter 30 m		JP47772
⑭	2x Schlauchbefestigung	2x Hose fastening	JP48141
⑮	2x Verschraubung	2x Hose connector	JP48142
⑯	2x Schlauch, 10m	2x Hose, 10m	JP48143
	2x Schlauch, 15m	2x Hose, 15m	JP48144
	2x Schlauch, 20m	2x Hose, 20m	JP48145
	2x Schlauch, 30m	2x Hose, 30m	JP48840
⑰	Luftglockenset, 10m	Pressure sensor set, 10m	JP48148
⑱	Luftglocke m Schlauch, 10m	Press. sensor w hose, 10m	JP47698
⑲	20x Fangflasche	20x Catch hanger	JP46904

BASICLOGO BD ... XM - BASICLOGO BD ... EXM

Ersatzteile - Spare parts - Pièces de rechange - Reserveonderdelen - Parti di ricambio - Reservedele - Reservdelar
 Varaoasat - Części zamienne - Náhradní díly - Alkatrészek - Piese de schimb - Запасные части - 备件

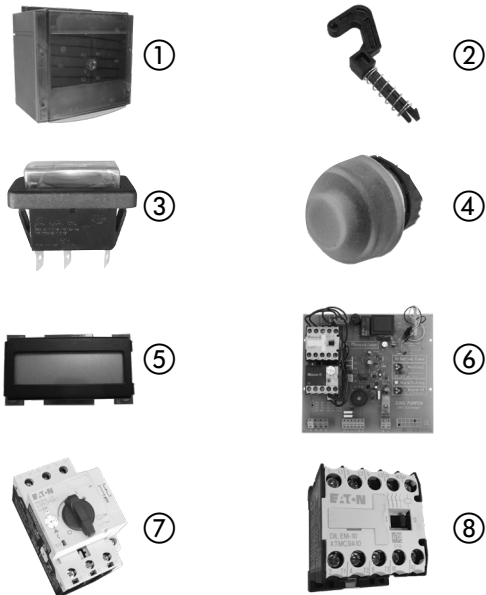

① Gehäuse A	Housing A	JP47692
② Scharnier	Hinge	JP48310
③ Wippschalter	Switch, 3 positions	JP47783
④ Taster	Button	JP48309
⑤ Betriebsstundenzähler	Operation hours counter	JP47672
⑥ Gedruckte Schaltung	PCB	JP47734
⑦ Motorschutzschalter	Protective motor switch	
	2,5-4 A	JP47753
	4-6,3 A	JP47754
	6,3-10 A	JP47755
⑧ Schütz DIL EM 10	Contactor EIL EM 10	JP47671

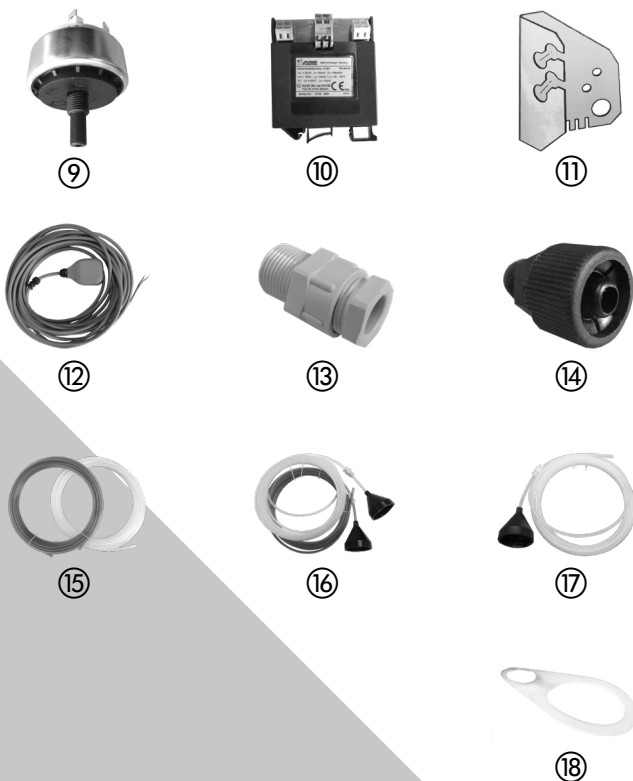

Niveaugeber	Level detector	
⑨ Druckschalter 100/50	Pressure switch	JP47699
⑩ Sicherheitsbarriere	Safety barrier ATEX	JP46348
⑪ TLS Halter		JP46456
⑫ TLS Tauchschalter 9,5m		JP48304
	TLS Tauchschalter 15 m	JP48873
	TLS Tauchschalter 20 m	JP47771
	TLS Tauchschalter 30 m	JP47772
⑬ 2x Schlauchbefestigung	2x Hose fastening	JP48141
⑭ 2x Verschraubung	2x Hose connector	JP48142
⑮ 2x Schlauch, 10m	2x Hose, 10m	JP48143
	2x Schlauch, 15m	JP48144
	2x Schlauch, 20m	JP48145
	2x Schlauch, 30m	JP48840
⑯ Luftglockenset, 10m	Pressure sensor set, 10m	JP48148
⑰ Luftglocke m Schlauch, 10m	Press. sensor w hose, 10m	JP47698
⑱ 20x Fangflasche	20x Catch hanger	JP46904